

- Sizes :** 1" to 12" Nominal Bore
- Pressure:** ASME300
- Flanges:** ASME B16.5 - RF
- Features:**
- Integrally cast housing
  - Bolted closure
  - Integral Flanged Drain & Vent
  - Red oxide finish (Carbon Steel only)
  - Ø 3 mm perforated hole plate as standard
  - Integral feet on 6" and over
- Advantages:**
- Large filtration area
  - Very low pressure losses dp
  - Extended cleaning intervals
  - European design
- Options:**
- Special baskets and special gaskets
  - Blind Flanges for Vent & Drain
  - DP tapping / Gauge
  - Magnetic Basket Insert
  - Drain / Vent Valves
  - Special Finish / Linings
- Standards:** PED 2014/68/EU  
ASME B16.5 RF Flange dimensions  
EN 10204 / NACE Certification  
Generally in accord. with ASME VIII Div. 1

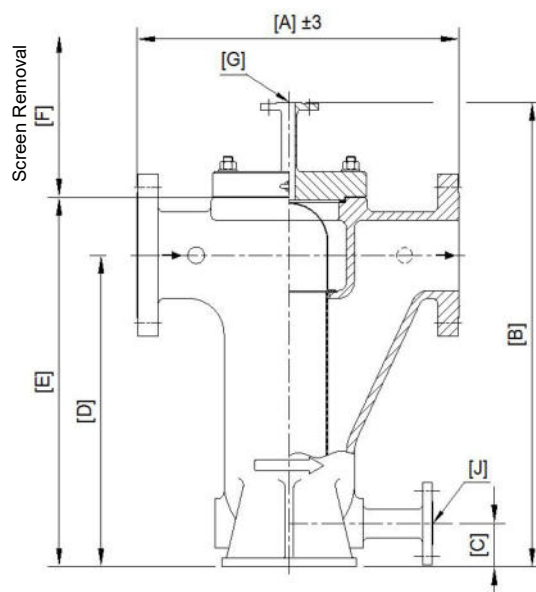

\* Note, bottom of drain flange is lower than the base on strainers without feet (1"NB to 4"NB).

All data is subject to confirmation at the time of order. Our policy is one of continual improvement and we reserve the right to amend details without prior notice.

### Technical Data

Size		Dimensions						Basket Area [cm <sup>2</sup> ]	Vent [G] (NB)	Drain [J] (NB)	Weight (kg)
mm	Inch	A	B	C *	D	E	F				
25	1"	232	325	27,5	190	226	245	241	3/4"	3/4"	14,5
40	1 1/2"	245	397	28,5	254	297	310	375	3/4"	3/4"	20,5
50	2"	321	463	38,0	314	362	380	488	3/4"	3/4"	28,0
80	3"	375	514	38,0	342	411	425	652	3/4"	3/4"	47,0
100	4"	455	613	49,0	426	509	505	1088	3/4"	1"	83,0
150	6"	620	903	95,0	619	747	685	2151	3/4"	1 1/2"	202,0
200	8"	740	1114	109,5	787	949	850	3973	3/4"	1 1/2"	362,0
250	10"	890	1273	120,0	908	1045	995	5304	3/4"	1 1/2"	535,0
300	12"	1050	1542	175,0	1152	1295	1265	8295	3/4"	2"	915,0

### Materials of Construction

Item	LT Carbon Steel	Carbon Steel	Stainless Steel
Strainer Body (cast)	ASTM A352 LCB/LCC Dual Cert	ASTM A216 WCB (~1.0619)	ASTM A351 CF8M (~1.4408)
Strainer Cover**	ASTM A352 LCB/LCC Dual Cert	ASTM A216 WCB (~1.0619)	ASTM A351 CF8M (~1.4408)
Strainer Basket	Stainless Steel 316 (Ø 3 mm perforated hole plate as standard / to customer specification)		
Cover Gasket	C.N.A.F. as standard / to customer specification		
Cover Stud Bolts	ASTM A320 Gr. L7 – zinc plated	ASTM A193 B7M – zinc plated	
Cover Full Nuts	ASTM A320 Gr. 7– zinc plated	ASTM A194 2HM – zinc plated	
Cover Washer	Carbon steel – zinc plated		

\*\*The strainer cover may be furnished from plate or casting depending upon size / availability.